

ADJUSTABLE CAMERA MOUNT - CABLE STYLE

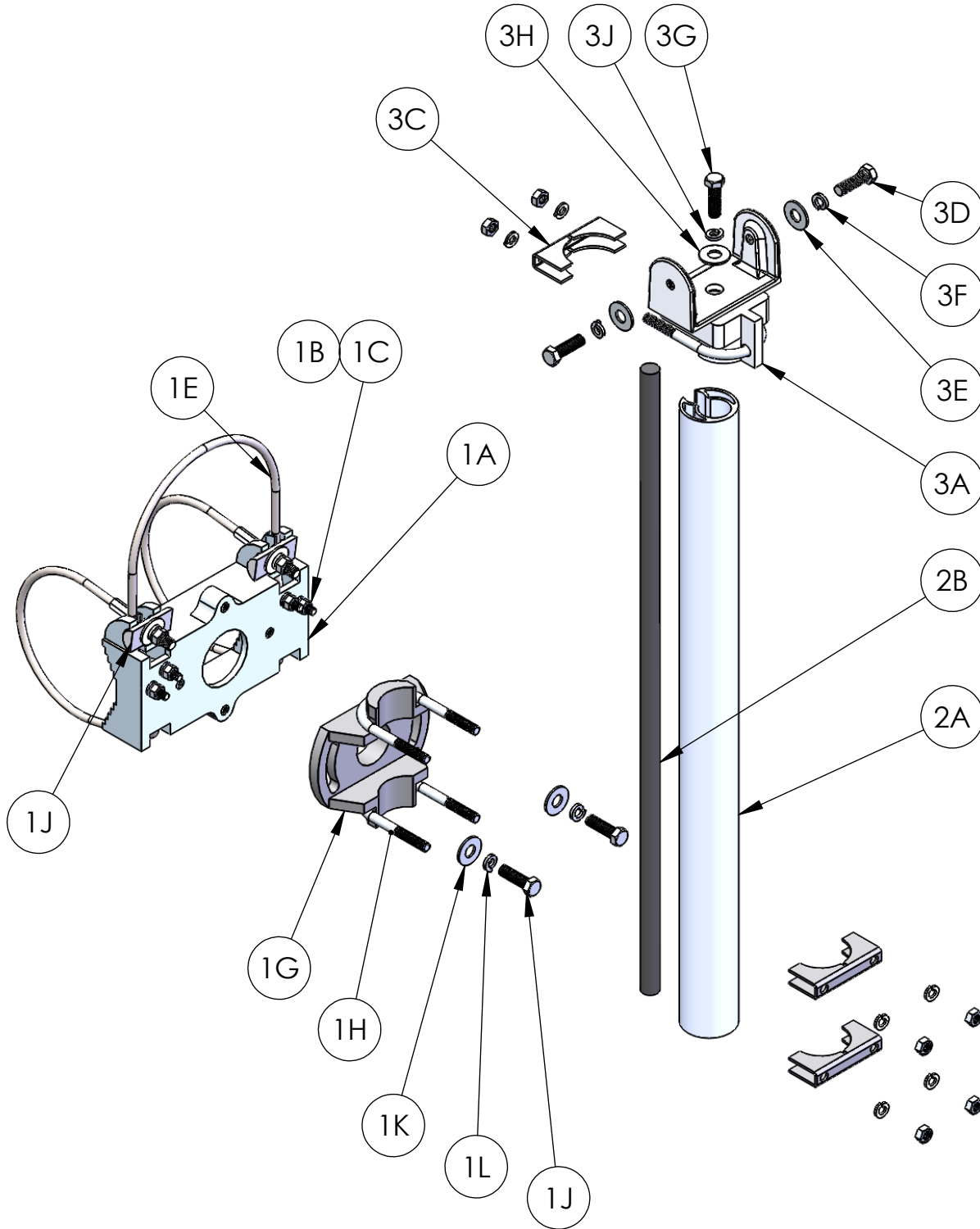

FOR					
STAINLESS STEEL					
ADJUSTABLE CAMERA MOUNT - CABLE STYLE					
ITEM	QTY	PART NUMBER	DESCRIPTION		
1	1	SS-SBCXX-SCK	KIT, CLAMP ASSEMBLY SS		
1A	1	1092-2-B	SADDLE, MACHINED		
1B	2		U-BOLT, CABLE LOCK SS		
1C	4	1086-26-SS	NUT, 5/16" HEX SS		
1D	4	46-0031	WASHER, 5/16" LOCK SS		
1E	2	46-0003	CABLE, ASSEMBLY 66" SS		
		46-0002	CABLE, ASSEMBLY 90" SS		
		46-0041	CABLE, ASSEMBLY 120" SS		
		46-0039	CABLE, ASSEMBLY 165" SS		
1F	2		STOP, CABLE		
1G	1	1086-1	SWIVEL CASTING		
1H	2	1086-17-SS	U-BOLT ASSEMBLY SS		
1J	2	1086-20-SS	BOLT, 3/8" X 1" HEX HEAD SS		
1K	2	1086-21-SS	WASHER, 3/8" FLAT SS		
1L	2	1086-22-SS	WASHER, 3/8" LOCK SS		
2	1	1086-8-XXTK	KIT, EXTRUSION TUBE		
2A	1	1086-8-24	EXTRUSION TUBE 24"		
		1086-8-37	EXTRUSION TUBE 37"		
		1086-8-46	EXTRUSION TUBE 46"		
		1086-8-60	EXTRUSION TUBE 60"		
		1086-8-74	EXTRUSION TUBE 74"		
		1086-8-96	EXTRUSION TUBE 96"		
2B	1	1086-10-24	FOAM SEAL 24"		
		1086-10-37	FOAM SEAL 37"		
		1086-10-46	FOAM SEAL 46"		
		1086-10-60	FOAM SEAL 60"		
		1086-10-74	FOAM SEAL 74"		
		1086-10-96	FOAM SEAL 96"		
3	1	SS-SB-ACMK	KIT, ADJUSTABLE CAMERA SS		
3A	1	0802-3-A	POLE TOP, MACHINED		
3B	1	0802-2-A	CAMERA YOKE, MACHINED		
3C	1	1086-17-SS	U-BOLT ASSEMBLY SS		
3D	2	1086-20-SS	BOLT, 3/8" X 1" HEX HEAD SS		
3E	2	1086-21-SS	WASHER, 3/8" FLAT SS		
3F	2	1086-22-SS	WASHER, 3/8" LOCK SS		
3G	1	46-0028	BOLT, 1/2" X 1" HEX HEAD SS		
3H	1	46-0006	WASHER, 1/2" FLAT SS		
3J	1	46-0025	WASHER, 1/2" LOCK SS		