

- (2) 3/8-16 BOLT
- (2) 3/8 FLAT WASHER
- (2) 3/8 SPLIT LOCK WASHER

- (2) BAND & BUCKLES
- 304 SS (BANDS)
- 316 SS (BUCKLES)

SWIVEL  
CAST 356 ALUMINUM  
(SIZED FOR 3" SCH. 40 ALUMINUM PIPE)

CLAMP SADDLE  
CAST 356 ALUMINUM

- (2) 3/8-18 U-BOLT
- (2) U-BOLT SADDLE
- (4) 3/8 NUTS
- (4) 3/8 LOCK WASHERS

(2) 3/8-16 BOLT

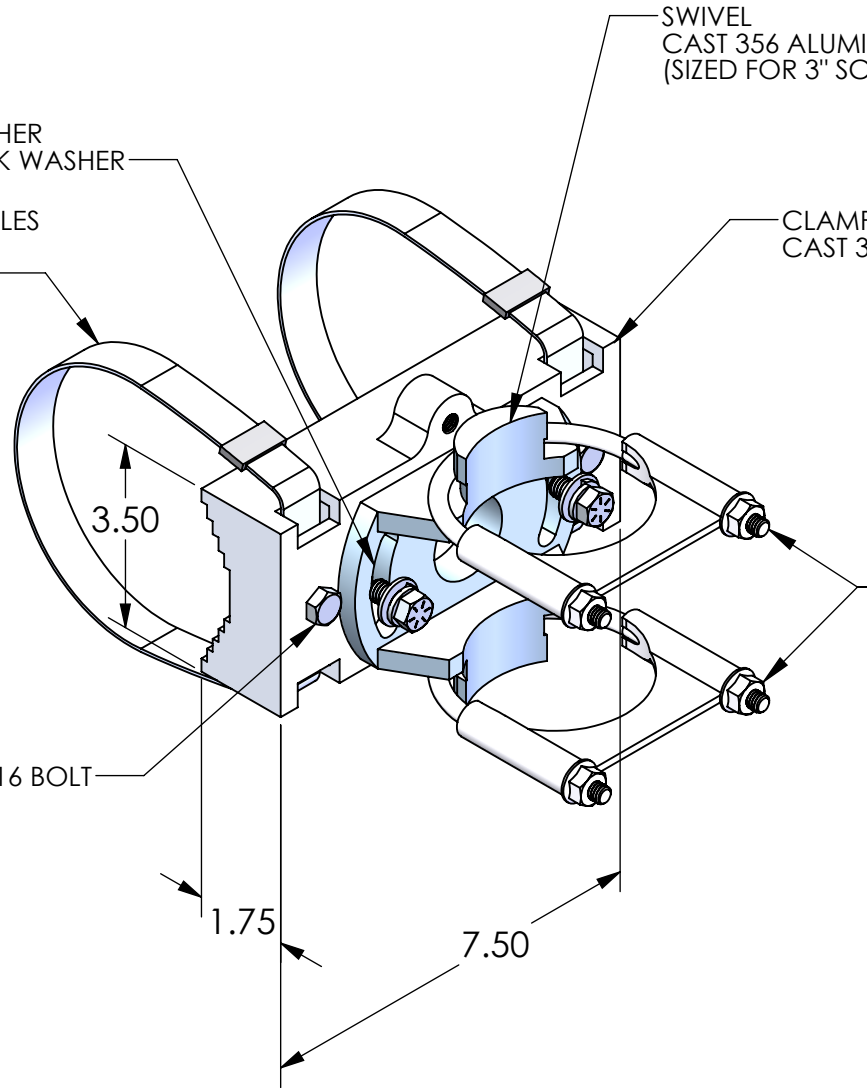

BAND LENGTH	MAST ARM DIA.
29"	3" - 7"
42"	7" - 11"
59"	12" - 15"
70"	18" - 21"

**PART NUMBER**  
**SB29-SCK-3**

BAND LENGTH

NOTES:  
1. YELLOW ZINC DICHROMATE PLATED FASTENERS, STAINLESS STEEL HARDWARE AVAILABLE.

THE INFORMATION CONTAINED IN THIS DRAWING IS THE SOLE PROPERTY OF SKYBRACKET. ANY REPRODUCTION IN PART OR WHOLE WITHOUT THE WRITTEN PERMISSION OF SKYBRACKET IS PROHIBITED.



APPROVALS	BY	DATE
DRAWN	TRC	1/15/14
SALES		
ENGINEERING		

TITLE		BAND CLAMP KIT (3" SCH. 40 PIPE)	
SIZE	DWG. NO.	REV.	
A	SB29-SCK-3	A	
DO NOT SCALE DRAWING		SCALE: NTS   CAD FILE: SB29-SCK-3	SHEET 1 OF 1